

ND LED Luminaire (IP Rated)

Luminaire Data

	L	Weight
ND2	14.8 in [376 mm]	12.3 lb [5.5 kg]
ND4	24.6 in [625 mm]	20.1 lb [9.0 kg]



ND2



ND4

*Drawing shows U-Bracket mounting option



ND2

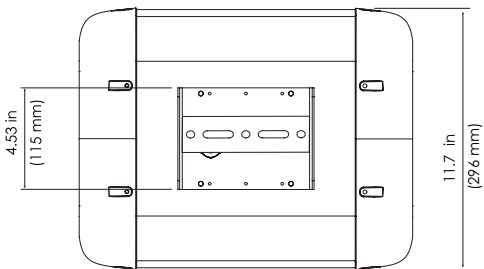
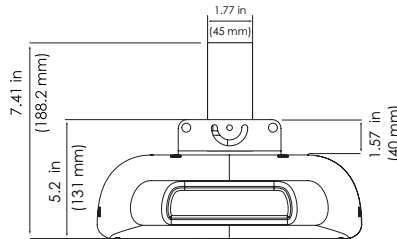
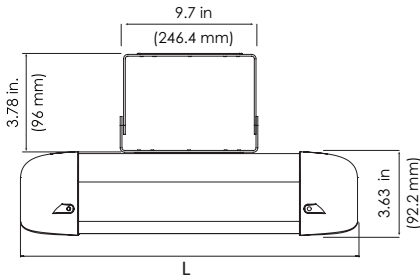

Ordering Information

Sample Catalog No. ND2 48H MV NW WS WH 700 P MSL3

Product & LED No. & Type	Voltage	Color Temperature	Distribution	Finish	Drive Current ¹	Mounting	Options
ND2 48H ND4 96H	MV 120-277V	NW 4000K	NS Narrow Symmetric	GY Gray	700 ² 700mA 350 350mA	S Suspension U U-Bracket P Pendant	MSL3 ³ Motion Sensor with L3 Lens
	HV 347-480V		AL Narrow Asymmetric				MSL7 ³ Motion Sensor with L7 Lens
			WS Wide Symmetric				FSIR100 Motion Sensor Configuration Tool

Notes:

- 1 Non-field adjustable drive current, see performance data on page 2 for selection
- 2 Consult factory for different drive current options
- 3 Only available for ND2-48H. Consult factory for ND4-96H



ND LED Luminaire (IP Rated)

Luminaire Specifications

Housing

Extruded aluminum housing with die-cast end caps is gasketed and sealed for IP66 rating.

Light Emitting Diodes

Hi-flux/Hi-power white LEDs are tested in accordance with IES LM-80 testing procedures. Neutral White (4000K) correlated color temperature available with minimum 70 CRI. LEDs are 100% mercury and lead free.

Optical Systems

Micro- lens systems produce distributions for Parking Deck, Underpass, Pedestrian Walkway, and Viaduct applications. Clear, UV stabilized polycarbonate optical cover standard. Luminaire produces 0% total lumens above 90° (BUG Rating, U=0).

Electrical

Power supply drive current is non-field adjustable (700mA). Power supply features a minimum power factor of .90 and <20% Total Harmonic Distortion (THD). EMC meets or exceeds FCC CFR Part 15. Transient voltage complies with ANSI C62.41 Cat. A. Integral surge protector is tested per ANSI/IEEE C62.45 procedures based on ANSI/IEEE C62.41.2 definitions for standard and optional waveforms for Location Category C High.

Finish

End caps receive a fade and abrasion resistant, epoxy polyester powder coat. Finish tested to withstand 5000 hours in salt spray exposure per ASTM B117. Finish tested 5000 hours in UV exposure per ASTM G154 and meets ASTM gloss retention. Aluminum extruded housing is anodized.

Listings/Ratings/Labels

Luminaires are UL listed for use in wet/damp/dry locations in the United States and Canada. DesignLights Consortium™ qualified product. Operating temperature is -40°C to 55°C. NSF/ANSI 2 Splash Zone rated for food equipment .

Photometry

Luminaires are photometrically tested by certified independent testing laboratories in accordance with IES LM-79 testing procedures.

Warranty

10-year limited warranty is standard on luminaire and components. 5-year limited warranty on luminaires with a motion sensor.

Performance Data

All data nominal, consult factory for IES files or LM-79 reports.

LED No. & Type	Optics	Drive Current (mA)	System Wattage (W)	Delivered Lumens (Lm)	Efficacy (Lm/W)	
ND2 48H	AL	700	108	11990	111	
ND4 96H			215	24000	112	
ND2 48H	NS		109	11870	109	
ND4 96H			213	23440	110	
ND2 48H	WS		109	11970	110	
ND4 96H			213	23490	111	
ND2 48H	WS		350	52	6860	131